

## DENVER F6 - 620 mm

Decoflame's Denver F6 bio-burner ranges from 520 mm to 3920 mm in length. Developed and manufactured locally, these burners offer exceptional flexibility for any project size. The Denver F6, designed by Decoflame's expert engineers, is a groundbreaking innovation in modern fireplaces. It impresses with advanced features, including app control, Bluetooth connectivity, and sophisticated safety systems. Additionally, it offers SmartHome integration and an external automated refuelling tank system, ensuring seamless and efficient operation.

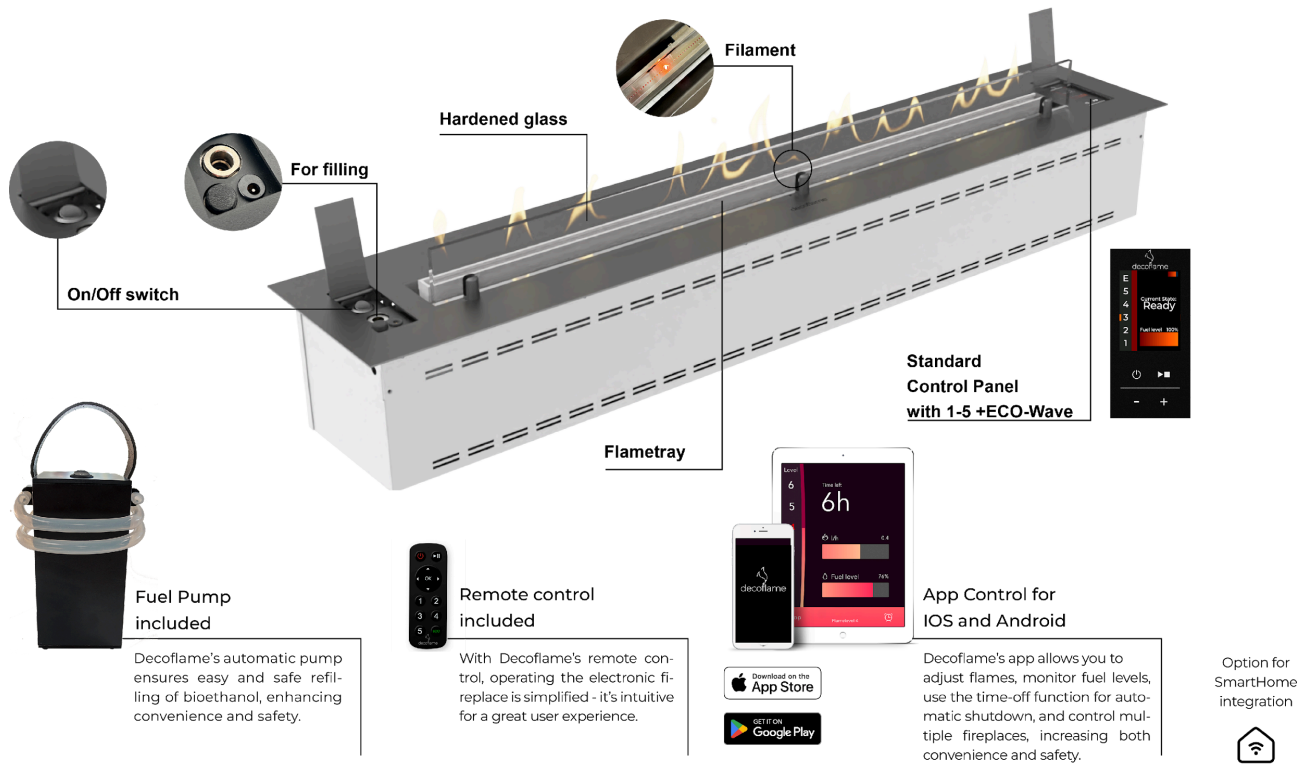

### GENERAL INFORMATION

Model	Denver F6
Configuration	620 mm
Operation Type	Electronic
Production	Made in Denmark

### DESIGN & MATERIALS

Material	Stainless steel / Powder coated aluminum
Finish	Standard black powder coating
Glass Quality	Tempered diamond clear glass
Standard Glass	1x Low Glass

**BURNER SPECIFICATIONS**

Fuel Type	Bioethanol 95 - 96.5 %
Flametray (mm)	400
Flame Levels	6 + ECO-Wave
Power Supply	230 V AC (220 V compatible), 50–60 Hz, earthed connection
Operation Type	Electronic
Chimney	Not Required

**PHYSICAL SPECIFICATIONS**

Gross Dimensions (mm)	W: 620 × H: 160 × D: 215
Top Plate (mm)	L: 620 × D: 215 × T: 2
Base Housing (mm)	W: 600 × H: 158 × D: 190
Glass Dimensions (mm)	Low Glass: L: 400 × H: 80 × T: 6
Weight: (kg)	13.0

**PERFORMANCE**

Capacity (L)	3.8
Max Level Burn Time (H)	8.0
Nominal Heat Output (kW)	2.6
Fuel consumption (ml/h)	N/A

**INSTALLATION REQUIREMENTS**

Power Supply	230 V AC (220 V compatible), 50–60 Hz, earthed connection
Minimum Room Size (m <sup>3</sup> )	51
Cut-out Dimensions (mm)	W: 605 × H: 200 × D: 400
Installation Environment	Indoor

**FEATURES**

Safety Features	Automatic emergency shut-off / Spill- and Safety sensors
Add-on Features	SmartHome integration / Preparation for Automatic Tank System / Automatic Tank System 60 L + 10 m cable and hose
Included Features	e-Ribbon Technology / Remote Control / App Operation / Large Fuel Tank / External Fuel Pump with Quick Connection

**DISCLAIMER – DECOFLAME A/S**

All product specifications and technical data are subject to change without prior notice and are considered accurate as of the date of publication. Decoflame A/S, including its affiliates, employees, agents and other representatives (collectively referred to as "Decoflame A/S"), disclaims all liability for any errors, inaccuracies, or omissions in this document or in any other product-related information. Decoflame A/S shall not be held liable for any damage, loss, or indirect consequences arising from the use, installation, or operation of the products, unless otherwise required under applicable law. It is the user's responsibility to ensure correct installation and usage in accordance with applicable safety standards and the manufacturer's instructions. No licence, whether express or implied, to any intellectual property rights is granted through this document. Customers who use or sell Decoflame A/S products for purposes not explicitly specified do so at their own risk and agree to indemnify Decoflame A/S against any claims or damages resulting from such use. Fuel consumption may vary depending on individual units, environmental conditions, and operating parameters. Product images are for illustrative purposes only and may differ from the actual product. This limitation of liability does not apply where it would conflict with mandatory consumer protection laws.

## DENVER F6 - 720 mm

Decoflame's Denver F6 bio-burner ranges from 520 mm to 3920 mm in length. Developed and manufactured locally, these burners offer exceptional flexibility for any project size. The Denver F6, designed by Decoflame's expert engineers, is a groundbreaking innovation in modern fireplaces. It impresses with advanced features, including app control, Bluetooth connectivity, and sophisticated safety systems. Additionally, it offers SmartHome integration and an external automated refuelling tank system, ensuring seamless and efficient operation.

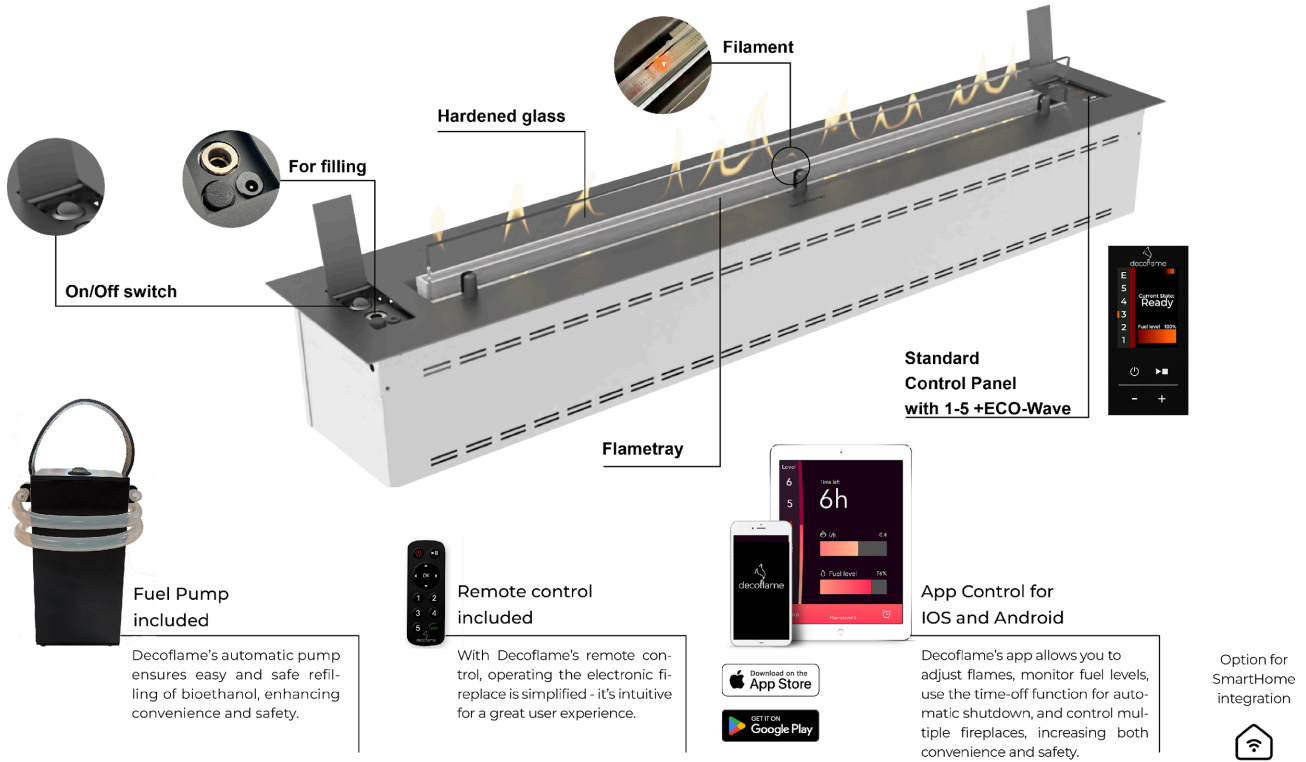

### GENERAL INFORMATION

Model	Denver F6
Configuration	720 mm
Operation Type	Electronic
Production	Made in Denmark

### DESIGN & MATERIALS

Material	Stainless steel / Powder coated aluminum
Finish	Standard black powder coating
Glass Quality	Tempered diamond clear glass
Standard Glass	1x Low Glass

**BURNER SPECIFICATIONS**

Fuel Type	Bioethanol 95 - 96.5 %
Flametray (mm)	500
Flame Levels	6 + ECO-Wave
Power Supply	230 V AC (220 V compatible), 50–60 Hz, earthed connection
Operation Type	Electronic
Chimney	Not Required

**PHYSICAL SPECIFICATIONS**

Gross Dimensions (mm)	W: 720 × H: 160 × D: 215
Top Plate (mm)	L: 720 × D: 215 × T: 2
Base Housing (mm)	W: 700 × H: 158 × D: 190
Glass Dimensions (mm)	Low Glass: L: 500 × H: 80 × T: 6
Weight: (kg)	15.0

**PERFORMANCE**

Capacity (L)	4.0
Max Level Burn Time (H)	7.0
Nominal Heat Output (kW)	4
Fuel consumption (ml/h)	N/A

**INSTALLATION REQUIREMENTS**

Power Supply	230 V AC (220 V compatible), 50–60 Hz, earthed connection
Minimum Room Size (m <sup>3</sup> )	64
Cut-out Dimensions (mm)	W: 705 × H: 200 × D: 400
Installation Environment	Indoor

**FEATURES**

Safety Features	Automatic emergency shut-off / Spill- and Safety sensors
Add-on Features	SmartHome integration / Preparation for Automatic Tank System / Automatic Tank System 60 L + 10 m cable and hose
Included Features	e-Ribbon Technology / Remote Control / App Operation / Large Fuel Tank / External Fuel Pump with Quick Connection

**DISCLAIMER – DECOFLAME A/S**

All product specifications and technical data are subject to change without prior notice and are considered accurate as of the date of publication. Decoflame A/S, including its affiliates, employees, agents and other representatives (collectively referred to as "Decoflame A/S"), disclaims all liability for any errors, inaccuracies, or omissions in this document or in any other product-related information. Decoflame A/S shall not be held liable for any damage, loss, or indirect consequences arising from the use, installation, or operation of the products, unless otherwise required under applicable law. It is the user's responsibility to ensure correct installation and usage in accordance with applicable safety standards and the manufacturer's instructions. No licence, whether express or implied, to any intellectual property rights is granted through this document. Customers who use or sell Decoflame A/S products for purposes not explicitly specified do so at their own risk and agree to indemnify Decoflame A/S against any claims or damages resulting from such use. Fuel consumption may vary depending on individual units, environmental conditions, and operating parameters. Product images are for illustrative purposes only and may differ from the actual product. This limitation of liability does not apply where it would conflict with mandatory consumer protection laws.

## DENVER F6 - 920 mm

Decoflame's Denver F6 bio-burner ranges from 520 mm to 3920 mm in length. Developed and manufactured locally, these burners offer exceptional flexibility for any project size. The Denver F6, designed by Decoflame's expert engineers, is a groundbreaking innovation in modern fireplaces. It impresses with advanced features, including app control, Bluetooth connectivity, and sophisticated safety systems. Additionally, it offers SmartHome integration and an external automated refuelling tank system, ensuring seamless and efficient operation.

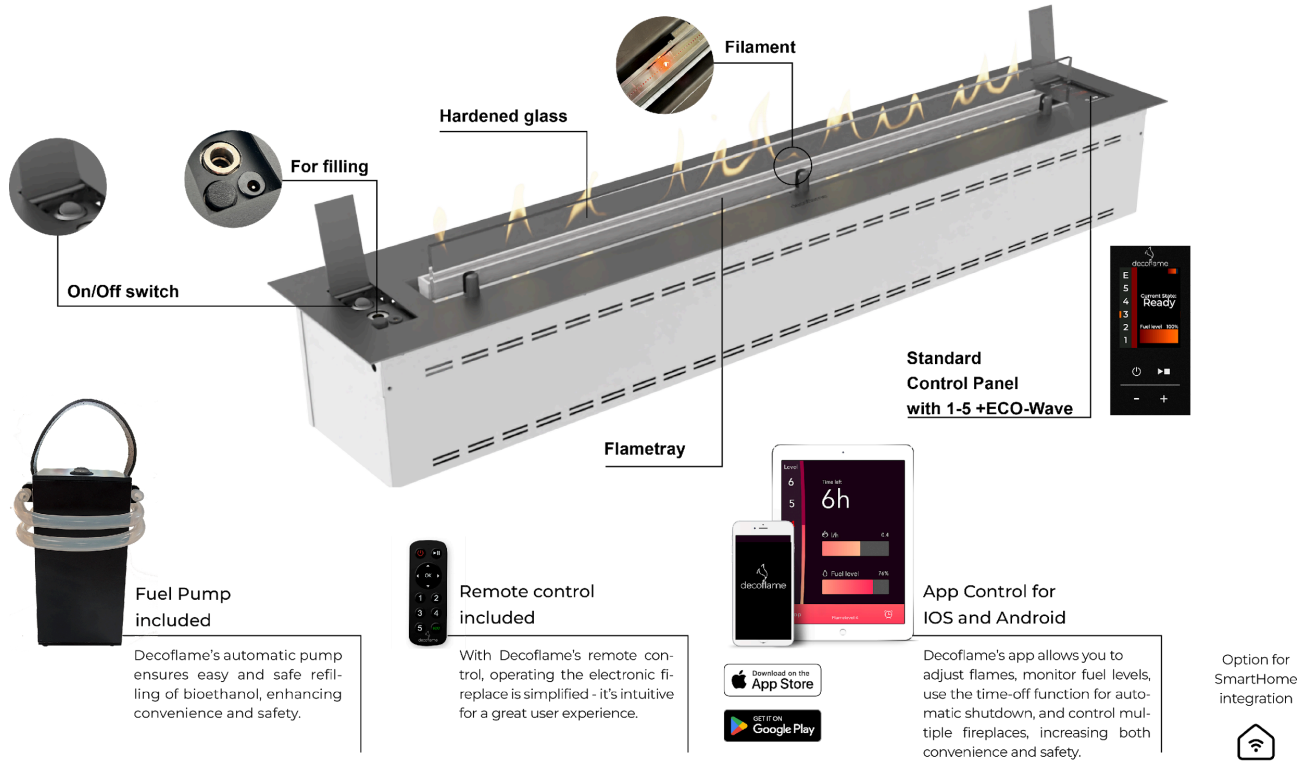

### GENERAL INFORMATION

Model	Denver F6
Configuration	920 mm
Operation Type	Electronic
Production	Made in Denmark

### DESIGN & MATERIALS

Material	Stainless steel / Powder coated aluminum
Finish	Standard black powder coating
Glass Quality	Tempered diamond clear glass
Standard Glass	1x Low Glass

**BURNER SPECIFICATIONS**

Fuel Type	Bioethanol 95 - 96.5 %
Flametray (mm)	700
Flame Levels	6 + ECO-Wave
Power Supply	230 V AC (220 V compatible), 50–60 Hz, earthed connection
Operation Type	Electronic
Chimney	Not Required

**PHYSICAL SPECIFICATIONS**

Gross Dimensions (mm)	W: 920 × H: 160 × D: 215
Top Plate (mm)	L: 920 × D: 215 × T: 2
Base Housing (mm)	W: 900 × H: 158 × D: 190
Glass Dimensions (mm)	Low Glass: L: 700 × H: 80 × T: 6
Weight: (kg)	19.0

**PERFORMANCE**

Capacity (L)	5.8
Max Level Burn Time (H)	7.5
Nominal Heat Output (kW)	4.3
Fuel consumption (ml/h)	N/A

**INSTALLATION REQUIREMENTS**

Power Supply	230 V AC (220 V compatible), 50–60 Hz, earthed connection
Minimum Room Size (m <sup>3</sup> )	89
Cut-out Dimensions (mm)	W: 905 × H: 200 × D: 400
Installation Environment	Indoor

**FEATURES**

Safety Features	Automatic emergency shut-off / Spill- and Safety sensors
Add-on Features	SmartHome integration / Preparation for Automatic Tank System / Automatic Tank System 60 L + 10 m cable and hose
Included Features	e-Ribbon Technology / Remote Control / App Operation / Large Fuel Tank / External Fuel Pump with Quick Connection

**DISCLAIMER – DECOFLAME A/S**

All product specifications and technical data are subject to change without prior notice and are considered accurate as of the date of publication. Decoflame A/S, including its affiliates, employees, agents and other representatives (collectively referred to as "Decoflame A/S"), disclaims all liability for any errors, inaccuracies, or omissions in this document or in any other product-related information. Decoflame A/S shall not be held liable for any damage, loss, or indirect consequences arising from the use, installation, or operation of the products, unless otherwise required under applicable law. It is the user's responsibility to ensure correct installation and usage in accordance with applicable safety standards and the manufacturer's instructions. No licence, whether express or implied, to any intellectual property rights is granted through this document. Customers who use or sell Decoflame A/S products for purposes not explicitly specified do so at their own risk and agree to indemnify Decoflame A/S against any claims or damages resulting from such use. Fuel consumption may vary depending on individual units, environmental conditions, and operating parameters. Product images are for illustrative purposes only and may differ from the actual product. This limitation of liability does not apply where it would conflict with mandatory consumer protection laws.

## DENVER F6 - 1120 mm

Decoflame's Denver F6 bio-burner ranges from 520 mm to 3920 mm in length. Developed and manufactured locally, these burners offer exceptional flexibility for any project size. The Denver F6, designed by Decoflame's expert engineers, is a groundbreaking innovation in modern fireplaces. It impresses with advanced features, including app control, Bluetooth connectivity, and sophisticated safety systems. Additionally, it offers SmartHome integration and an external automated refuelling tank system, ensuring seamless and efficient operation.

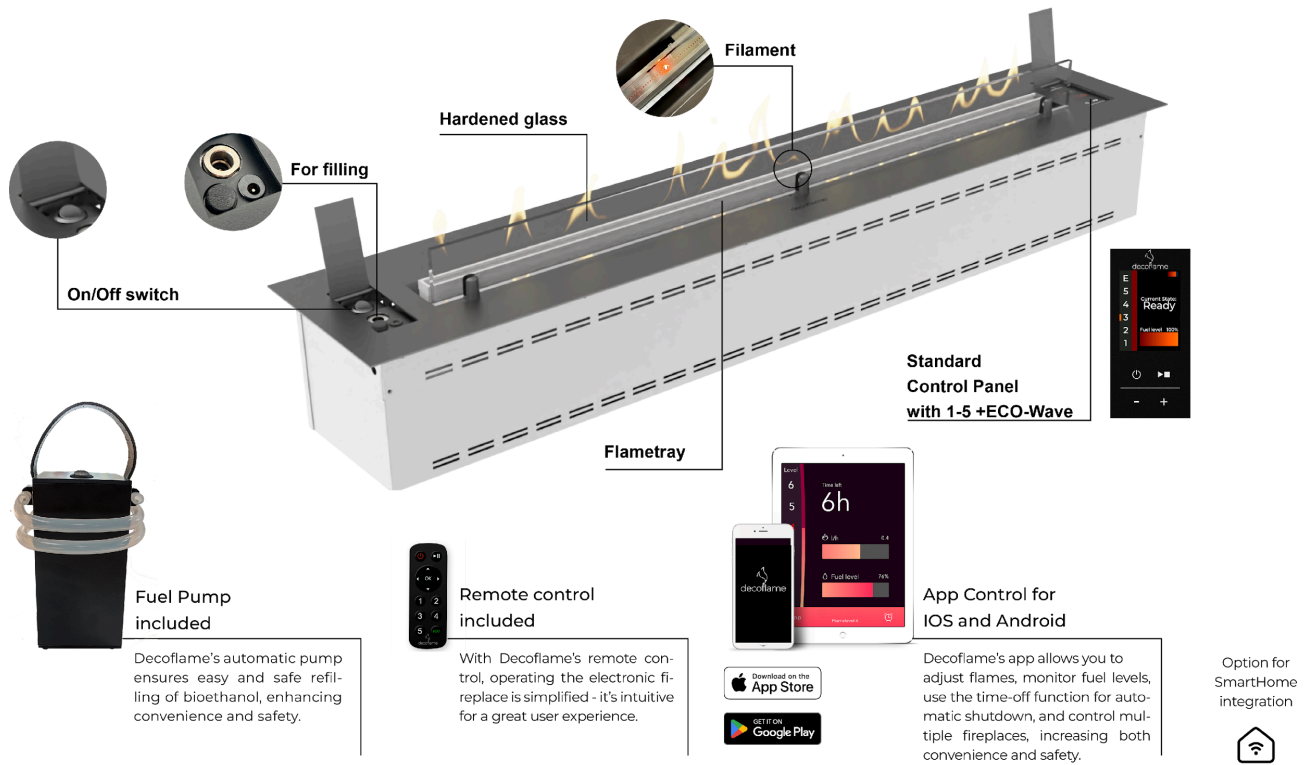

### GENERAL INFORMATION

Model	Denver F6
Configuration	1120 mm
Operation Type	Electronic
Production	Made in Denmark

### DESIGN & MATERIALS

Material	Stainless steel / Powder coated aluminum
Finish	Standard black powder coating
Glass Quality	Tempered diamond clear glass
Standard Glass	1x Low Glass

**BURNER SPECIFICATIONS**

Fuel Type	Bioethanol 95 - 96.5 %
Flametray (mm)	900
Flame Levels	6 + ECO-Wave
Power Supply	230 V AC (220 V compatible), 50–60 Hz, earthed connection
Operation Type	Electronic
Chimney	Not Required

**PHYSICAL SPECIFICATIONS**

Gross Dimensions (mm)	W: 1120 × H: 160 × D: 215
Top Plate (mm)	L: 1120 × D: 215 × T: 2
Base Housing (mm)	W: 1100 × H: 158 × D: 190
Glass Dimensions (mm)	Low Glass: L: 900 × H: 80 × T: 6
Weight: (kg)	21.0

**PERFORMANCE**

Capacity (L)	7.2
Max Level Burn Time (H)	7.0
Nominal Heat Output (kW)	5.7
Fuel consumption (ml/h)	N/A

**INSTALLATION REQUIREMENTS**

Power Supply	230 V AC (220 V compatible), 50–60 Hz, earthed connection
Minimum Room Size (m <sup>3</sup> )	115
Cut-out Dimensions (mm)	W: 1105 × H: 200 × D: 400
Installation Environment	Indoor

**FEATURES**

Safety Features	Automatic emergency shut-off / Spill- and Safety sensors
Add-on Features	SmartHome integration / Preparation for Automatic Tank System / Automatic Tank System 60 L + 10 m cable and hose
Included Features	e-Ribbon Technology / Remote Control / App Operation / Large Fuel Tank / External Fuel Pump with Quick Connection

**DISCLAIMER – DECOFLAME A/S**

All product specifications and technical data are subject to change without prior notice and are considered accurate as of the date of publication. Decoflame A/S, including its affiliates, employees, agents and other representatives (collectively referred to as "Decoflame A/S"), disclaims all liability for any errors, inaccuracies, or omissions in this document or in any other product-related information. Decoflame A/S shall not be held liable for any damage, loss, or indirect consequences arising from the use, installation, or operation of the products, unless otherwise required under applicable law. It is the user's responsibility to ensure correct installation and usage in accordance with applicable safety standards and the manufacturer's instructions. No licence, whether express or implied, to any intellectual property rights is granted through this document. Customers who use or sell Decoflame A/S products for purposes not explicitly specified do so at their own risk and agree to indemnify Decoflame A/S against any claims or damages resulting from such use. Fuel consumption may vary depending on individual units, environmental conditions, and operating parameters. Product images are for illustrative purposes only and may differ from the actual product. This limitation of liability does not apply where it would conflict with mandatory consumer protection laws.

## DENVER F6 - 1320 mm

Decoflame's Denver F6 bio-burner ranges from 520 mm to 3920 mm in length. Developed and manufactured locally, these burners offer exceptional flexibility for any project size. The Denver F6, designed by Decoflame's expert engineers, is a groundbreaking innovation in modern fireplaces. It impresses with advanced features, including app control, Bluetooth connectivity, and sophisticated safety systems. Additionally, it offers SmartHome integration and an external automated refuelling tank system, ensuring seamless and efficient operation.

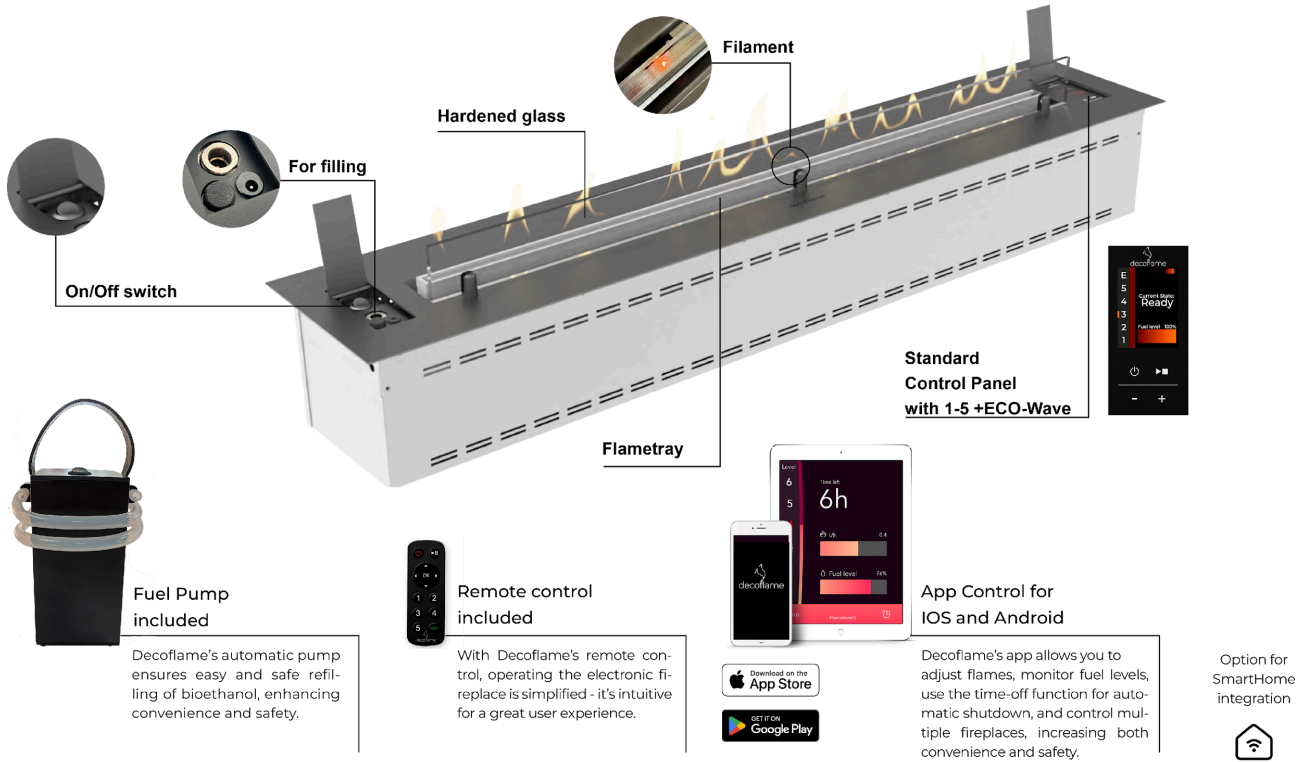

### GENERAL INFORMATION

Model	Denver F6
Configuration	1320 mm
Operation Type	Electronic
Production	Made in Denmark

### DESIGN & MATERIALS

Material	Stainless steel / Powder coated aluminum
Finish	Standard black powder coating
Glass Quality	Tempered diamond clear glass
Standard Glass	1x Low Glass

**BURNER SPECIFICATIONS**

Fuel Type	Bioethanol 95 - 96.5 %
Flametray (mm)	1100
Flame Levels	6 + ECO-Wave
Power Supply	230 V AC (220 V compatible), 50–60 Hz, earthed connection
Operation Type	Electronic
Chimney	Not Required

**PHYSICAL SPECIFICATIONS**

Gross Dimensions (mm)	W: 1320 × H: 160 × D: 215
Top Plate (mm)	L: 1320 × D: 215 × T: 2
Base Housing (mm)	W: 1300 × H: 158 × D: 190
Glass Dimensions (mm)	Low Glass: L: 1100 × H: 80 × T: 6
Weight: (kg)	23.0

**PERFORMANCE**

Capacity (L)	8.4
Max Level Burn Time (H)	7.0
Nominal Heat Output (kW)	7
Fuel consumption (ml/h)	N/A

**INSTALLATION REQUIREMENTS**

Power Supply	230 V AC (220 V compatible), 50–60 Hz, earthed connection
Minimum Room Size (m <sup>3</sup> )	140
Cut-out Dimensions (mm)	W: 1305 × H: 200 × D: 400
Installation Environment	Indoor

**FEATURES**

Safety Features	Automatic emergency shut-off / Spill- and Safety sensors
Add-on Features	SmartHome integration / Preparation for Automatic Tank System / Automatic Tank System 60 L + 10 m cable and hose
Included Features	e-Ribbon Technology / Remote Control / App Operation / Large Fuel Tank / External Fuel Pump with Quick Connection

**DISCLAIMER – DECOFLAME A/S**

All product specifications and technical data are subject to change without prior notice and are considered accurate as of the date of publication. Decoflame A/S, including its affiliates, employees, agents and other representatives (collectively referred to as "Decoflame A/S"), disclaims all liability for any errors, inaccuracies, or omissions in this document or in any other product-related information. Decoflame A/S shall not be held liable for any damage, loss, or indirect consequences arising from the use, installation, or operation of the products, unless otherwise required under applicable law. It is the user's responsibility to ensure correct installation and usage in accordance with applicable safety standards and the manufacturer's instructions. No licence, whether express or implied, to any intellectual property rights is granted through this document. Customers who use or sell Decoflame A/S products for purposes not explicitly specified do so at their own risk and agree to indemnify Decoflame A/S against any claims or damages resulting from such use. Fuel consumption may vary depending on individual units, environmental conditions, and operating parameters. Product images are for illustrative purposes only and may differ from the actual product. This limitation of liability does not apply where it would conflict with mandatory consumer protection laws.

## DENVER F6 - 1520 mm

Decoflame's Denver F6 bio-burner ranges from 520 mm to 3920 mm in length. Developed and manufactured locally, these burners offer exceptional flexibility for any project size. The Denver F6, designed by Decoflame's expert engineers, is a groundbreaking innovation in modern fireplaces. It impresses with advanced features, including app control, Bluetooth connectivity, and sophisticated safety systems. Additionally, it offers SmartHome integration and an external automated refuelling tank system, ensuring seamless and efficient operation.

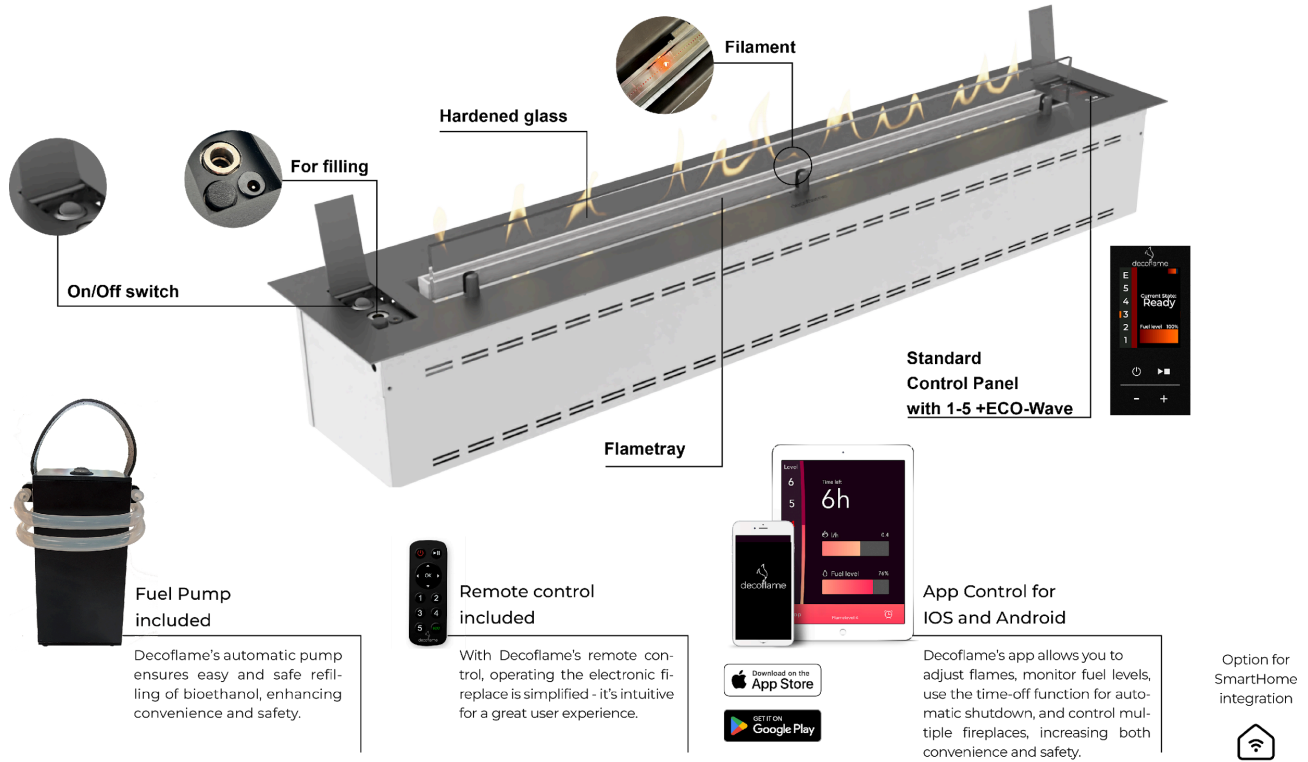

### GENERAL INFORMATION

Model	Denver F6
Configuration	1520 mm
Operation Type	Electronic
Production	Made in Denmark

### DESIGN & MATERIALS

Material	Stainless steel / Powder coated aluminum
Finish	Standard black powder coating
Glass Quality	Tempered diamond clear glass
Standard Glass	1x Low Glass

**BURNER SPECIFICATIONS**

Fuel Type	Bioethanol 95 - 96.5 %
Flametray (mm)	1300
Flame Levels	6 + ECO-Wave
Power Supply	230 V AC (220 V compatible), 50–60 Hz, earthed connection
Operation Type	Electronic
Chimney	Not Required

**PHYSICAL SPECIFICATIONS**

Gross Dimensions (mm)	W: 1520 × H: 160 × D: 215
Top Plate (mm)	L: 1520 × D: 215 × T: 2
Base Housing (mm)	W: 1500 × H: 158 × D: 190
Glass Dimensions (mm)	Low Glass: L: 1300 × H: 80 × T: 6
Weight: (kg)	25.0

**PERFORMANCE**

Capacity (L)	9.7
Max Level Burn Time (H)	6.5
Nominal Heat Output (kW)	8.3
Fuel consumption (ml/h)	N/A

**INSTALLATION REQUIREMENTS**

Power Supply	230 V AC (220 V compatible), 50–60 Hz, earthed connection
Minimum Room Size (m <sup>3</sup> )	166
Cut-out Dimensions (mm)	W: 1505 × H: 200 × D: 400
Installation Environment	Indoor

**FEATURES**

Safety Features	Automatic emergency shut-off / Spill- and Safety sensors
Add-on Features	SmartHome integration / Preparation for Automatic Tank System / Automatic Tank System 60 L + 10 m cable and hose
Included Features	e-Ribbon Technology / Remote Control / App Operation / Large Fuel Tank / External Fuel Pump with Quick Connection

**DISCLAIMER – DECOFLAME A/S**

All product specifications and technical data are subject to change without prior notice and are considered accurate as of the date of publication. Decoflame A/S, including its affiliates, employees, agents and other representatives (collectively referred to as "Decoflame A/S"), disclaims all liability for any errors, inaccuracies, or omissions in this document or in any other product-related information. Decoflame A/S shall not be held liable for any damage, loss, or indirect consequences arising from the use, installation, or operation of the products, unless otherwise required under applicable law. It is the user's responsibility to ensure correct installation and usage in accordance with applicable safety standards and the manufacturer's instructions. No licence, whether express or implied, to any intellectual property rights is granted through this document. Customers who use or sell Decoflame A/S products for purposes not explicitly specified do so at their own risk and agree to indemnify Decoflame A/S against any claims or damages resulting from such use. Fuel consumption may vary depending on individual units, environmental conditions, and operating parameters. Product images are for illustrative purposes only and may differ from the actual product. This limitation of liability does not apply where it would conflict with mandatory consumer protection laws.

## DENVER F6 - 1720 mm

Decoflame's Denver F6 bio-burner ranges from 520 mm to 3920 mm in length. Developed and manufactured locally, these burners offer exceptional flexibility for any project size. The Denver F6, designed by Decoflame's expert engineers, is a groundbreaking innovation in modern fireplaces. It impresses with advanced features, including app control, Bluetooth connectivity, and sophisticated safety systems. Additionally, it offers SmartHome integration and an external automated refuelling tank system, ensuring seamless and efficient operation.

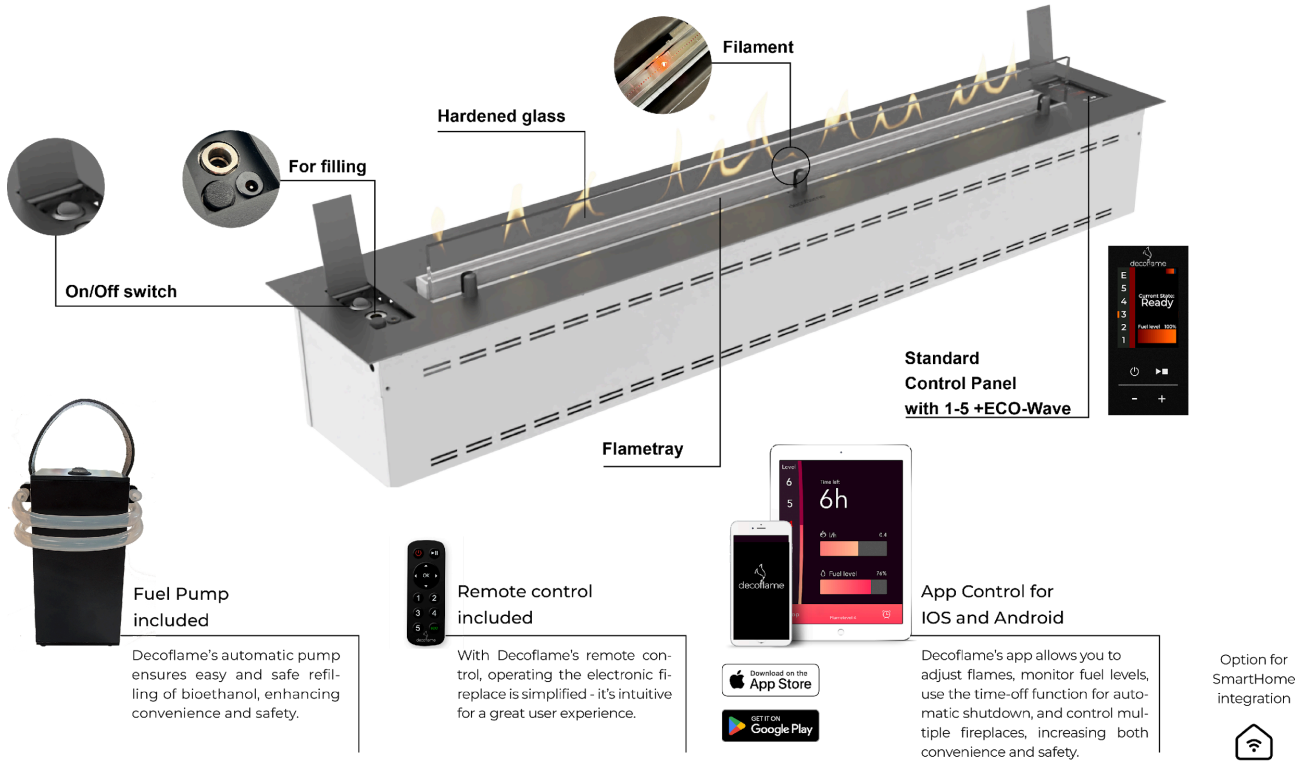

### GENERAL INFORMATION

Model	Denver F6
Configuration	1720 mm
Operation Type	Electronic
Production	Made in Denmark

### DESIGN & MATERIALS

Material	Stainless steel / Powder coated aluminum
Finish	Standard black powder coating
Glass Quality	Tempered diamond clear glass
Standard Glass	1x Low Glass

**BURNER SPECIFICATIONS**

Fuel Type	Bioethanol 95 - 96.5 %
Flametray (mm)	1500
Flame Levels	6 + ECO-Wave
Power Supply	230 V AC (220 V compatible), 50–60 Hz, earthed connection
Operation Type	Electronic
Chimney	Not Required

**PHYSICAL SPECIFICATIONS**

Gross Dimensions (mm)	W: 1720 × H: 160 × D: 215
Top Plate (mm)	L: 1720 × D: 215 × T: 2
Base Housing (mm)	W: 1700 × H: 158 × D: 190
Glass Dimensions (mm)	Low Glass: L: 1500 × H: 80 × T: 6
Weight: (kg)	27.0

**PERFORMANCE**

Capacity (L)	11.1
Max Level Burn Time (H)	6.5
Nominal Heat Output (kW)	9.6
Fuel consumption (ml/h)	N/A

**INSTALLATION REQUIREMENTS**

Power Supply	230 V AC (220 V compatible), 50–60 Hz, earthed connection
Minimum Room Size (m <sup>3</sup> )	191
Cut-out Dimensions (mm)	W: 1705 × H: 200 × D: 400
Installation Environment	Indoor

**FEATURES**

Safety Features	Automatic emergency shut-off / Spill- and Safety sensors
Add-on Features	SmartHome integration / Preparation for Automatic Tank System / Automatic Tank System 60 L + 10 m cable and hose
Included Features	e-Ribbon Technology / Remote Control / App Operation / Large Fuel Tank / External Fuel Pump with Quick Connection

**DISCLAIMER – DECOFLAME A/S**

All product specifications and technical data are subject to change without prior notice and are considered accurate as of the date of publication. Decoflame A/S, including its affiliates, employees, agents and other representatives (collectively referred to as "Decoflame A/S"), disclaims all liability for any errors, inaccuracies, or omissions in this document or in any other product-related information. Decoflame A/S shall not be held liable for any damage, loss, or indirect consequences arising from the use, installation, or operation of the products, unless otherwise required under applicable law. It is the user's responsibility to ensure correct installation and usage in accordance with applicable safety standards and the manufacturer's instructions. No licence, whether express or implied, to any intellectual property rights is granted through this document. Customers who use or sell Decoflame A/S products for purposes not explicitly specified do so at their own risk and agree to indemnify Decoflame A/S against any claims or damages resulting from such use. Fuel consumption may vary depending on individual units, environmental conditions, and operating parameters. Product images are for illustrative purposes only and may differ from the actual product. This limitation of liability does not apply where it would conflict with mandatory consumer protection laws.

## DENVER F6 - 1920 mm

Decoflame's Denver F6 bio-burner ranges from 520 mm to 3920 mm in length. Developed and manufactured locally, these burners offer exceptional flexibility for any project size. The Denver F6, designed by Decoflame's expert engineers, is a groundbreaking innovation in modern fireplaces. It impresses with advanced features, including app control, Bluetooth connectivity, and sophisticated safety systems. Additionally, it offers SmartHome integration and an external automated refuelling tank system, ensuring seamless and efficient operation.

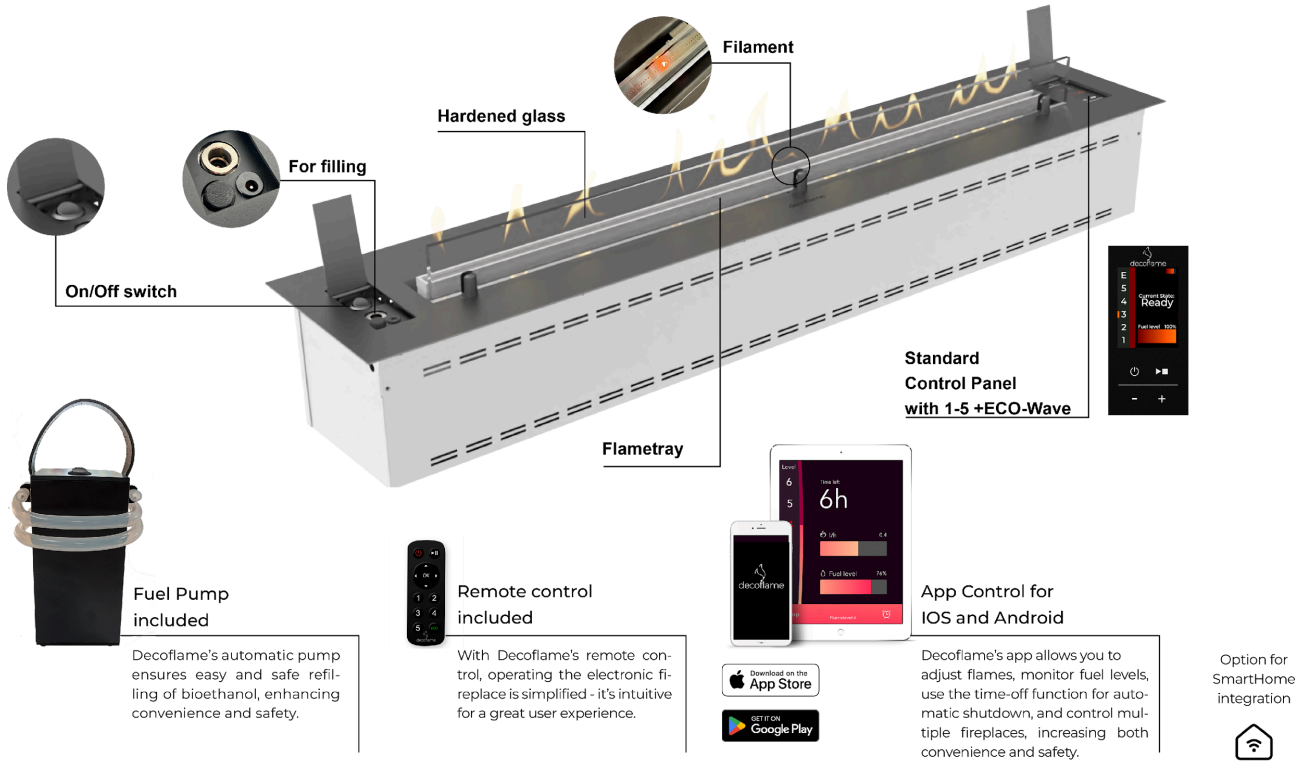

### GENERAL INFORMATION

Model	Denver F6
Configuration	1920 mm
Operation Type	Electronic
Production	Made in Denmark

### DESIGN & MATERIALS

Material	Stainless steel / Powder coated aluminum
Finish	Standard black powder coating
Glass Quality	Tempered diamond clear glass
Standard Glass	1x Low Glass

**BURNER SPECIFICATIONS**

Fuel Type	Bioethanol 95 - 96.5 %
Flametray (mm)	1700
Flame Levels	6 + ECO-Wave
Power Supply	230 V AC (220 V compatible), 50–60 Hz, earthed connection
Operation Type	Electronic
Chimney	Not Required

**PHYSICAL SPECIFICATIONS**

Gross Dimensions (mm)	W: 1920 × H: 160 × D: 215
Top Plate (mm)	L: 1920 × D: 215 × T: 2
Base Housing (mm)	W: 1900 × H: 158 × D: 190
Glass Dimensions (mm)	Low Glass: L: 1700 × H: 80 × T: 6
Weight: (kg)	29.0

**PERFORMANCE**

Capacity (L)	12.4
Max Level Burn Time (H)	6.5
Nominal Heat Output (kW)	10.8
Fuel consumption (ml/h)	N/A

**INSTALLATION REQUIREMENTS**

Power Supply	230 V AC (220 V compatible), 50–60 Hz, earthed connection
Minimum Room Size (m <sup>3</sup> )	217
Cut-out Dimensions (mm)	W: 1905 × H: 200 × D: 400
Installation Environment	Indoor

**FEATURES**

Safety Features	Automatic emergency shut-off / Spill- and Safety sensors
Add-on Features	SmartHome integration / Preparation for Automatic Tank System / Automatic Tank System 60 L + 10 m cable and hose
Included Features	e-Ribbon Technology / Remote Control / App Operation / Large Fuel Tank / External Fuel Pump with Quick Connection

**DISCLAIMER – DECOFLAME A/S**

All product specifications and technical data are subject to change without prior notice and are considered accurate as of the date of publication. Decoflame A/S, including its affiliates, employees, agents and other representatives (collectively referred to as "Decoflame A/S"), disclaims all liability for any errors, inaccuracies, or omissions in this document or in any other product-related information. Decoflame A/S shall not be held liable for any damage, loss, or indirect consequences arising from the use, installation, or operation of the products, unless otherwise required under applicable law. It is the user's responsibility to ensure correct installation and usage in accordance with applicable safety standards and the manufacturer's instructions. No licence, whether express or implied, to any intellectual property rights is granted through this document. Customers who use or sell Decoflame A/S products for purposes not explicitly specified do so at their own risk and agree to indemnify Decoflame A/S against any claims or damages resulting from such use. Fuel consumption may vary depending on individual units, environmental conditions, and operating parameters. Product images are for illustrative purposes only and may differ from the actual product. This limitation of liability does not apply where it would conflict with mandatory consumer protection laws.

## DENVER F6 - 2120 mm

Decoflame's Denver F6 bio-burner ranges from 520 mm to 3920 mm in length. Developed and manufactured locally, these burners offer exceptional flexibility for any project size. The Denver F6, designed by Decoflame's expert engineers, is a groundbreaking innovation in modern fireplaces. It impresses with advanced features, including app control, Bluetooth connectivity, and sophisticated safety systems. Additionally, it offers SmartHome integration and an external automated refuelling tank system, ensuring seamless and efficient operation.

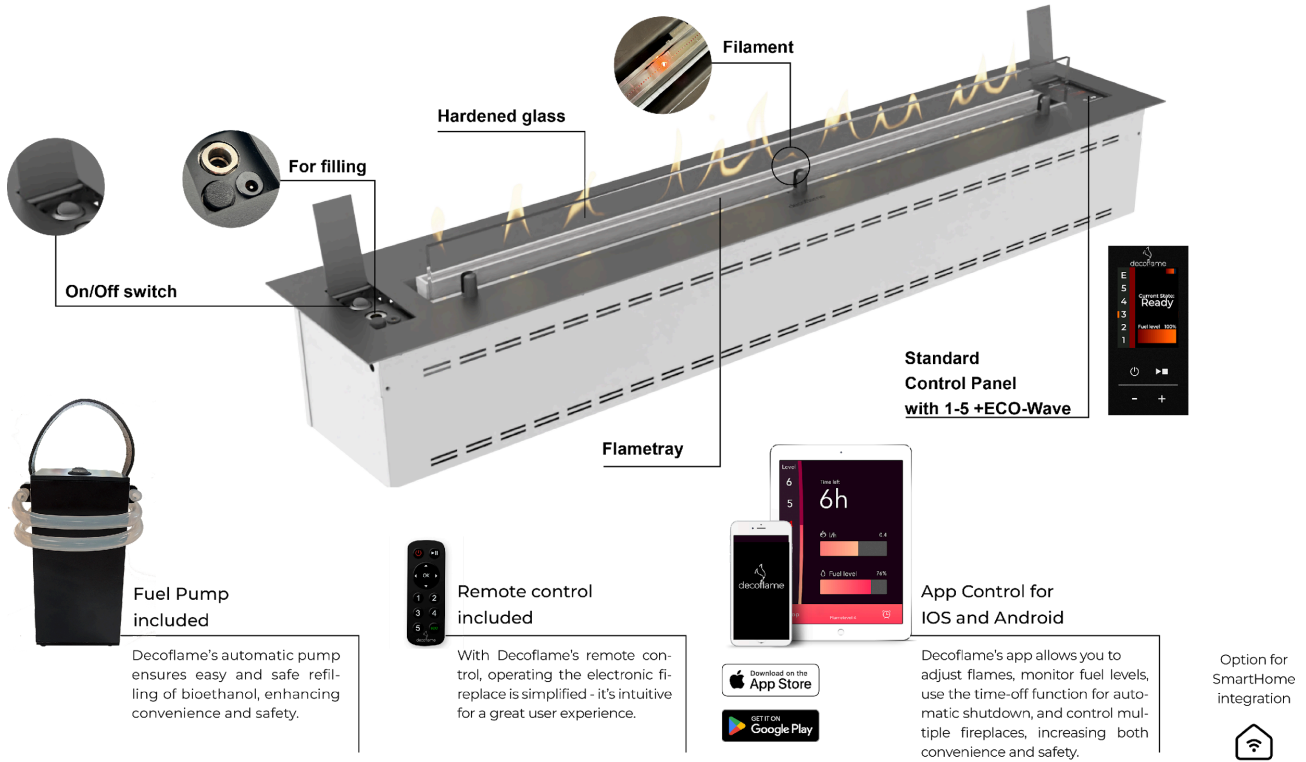

### GENERAL INFORMATION

Model	Denver F6
Configuration	2120 mm
Operation Type	Electronic
Production	Made in Denmark

### DESIGN & MATERIALS

Material	Stainless steel / Powder coated aluminum
Finish	Standard black powder coating
Glass Quality	Tempered diamond clear glass
Standard Glass	1x Low Glass

**BURNER SPECIFICATIONS**

Fuel Type	Bioethanol 95 - 96.5 %
Flametray (mm)	1900
Flame Levels	6 + ECO-Wave
Power Supply	230 V AC (220 V compatible), 50–60 Hz, earthed connection
Operation Type	Electronic
Chimney	Not Required

**PHYSICAL SPECIFICATIONS**

Gross Dimensions (mm)	W: 2120 × H: 160 × D: 215
Top Plate (mm)	L: 2120 × D: 215 × T: 2
Base Housing (mm)	W: 2100 × H: 158 × D: 190
Glass Dimensions (mm)	Low Glass: L: 1900 × H: 80 × T: 6
Weight: (kg)	31.0

**PERFORMANCE**

Capacity (L)	13.7
Max Level Burn Time (H)	6.5
Nominal Heat Output (kW)	12.1
Fuel consumption (ml/h)	N/A

**INSTALLATION REQUIREMENTS**

Power Supply	230 V AC (220 V compatible), 50–60 Hz, earthed connection
Minimum Room Size (m <sup>3</sup> )	243
Cut-out Dimensions (mm)	W: 2105 × H: 200 × D: 400
Installation Environment	Indoor

**FEATURES**

Safety Features	Automatic emergency shut-off / Spill- and Safety sensors
Add-on Features	SmartHome integration / Preparation for Automatic Tank System / Automatic Tank System 60 L + 10 m cable and hose
Included Features	e-Ribbon Technology / Remote Control / App Operation / Large Fuel Tank / External Fuel Pump with Quick Connection

**DISCLAIMER – DECOFLAME A/S**

All product specifications and technical data are subject to change without prior notice and are considered accurate as of the date of publication. Decoflame A/S, including its affiliates, employees, agents and other representatives (collectively referred to as "Decoflame A/S"), disclaims all liability for any errors, inaccuracies, or omissions in this document or in any other product-related information. Decoflame A/S shall not be held liable for any damage, loss, or indirect consequences arising from the use, installation, or operation of the products, unless otherwise required under applicable law. It is the user's responsibility to ensure correct installation and usage in accordance with applicable safety standards and the manufacturer's instructions. No licence, whether express or implied, to any intellectual property rights is granted through this document. Customers who use or sell Decoflame A/S products for purposes not explicitly specified do so at their own risk and agree to indemnify Decoflame A/S against any claims or damages resulting from such use. Fuel consumption may vary depending on individual units, environmental conditions, and operating parameters. Product images are for illustrative purposes only and may differ from the actual product. This limitation of liability does not apply where it would conflict with mandatory consumer protection laws.

## DENVER F6 - 2320 mm

Decoflame's Denver F6 bio-burner ranges from 520 mm to 3920 mm in length. Developed and manufactured locally, these burners offer exceptional flexibility for any project size. The Denver F6, designed by Decoflame's expert engineers, is a groundbreaking innovation in modern fireplaces. It impresses with advanced features, including app control, Bluetooth connectivity, and sophisticated safety systems. Additionally, it offers SmartHome integration and an external automated refuelling tank system, ensuring seamless and efficient operation.

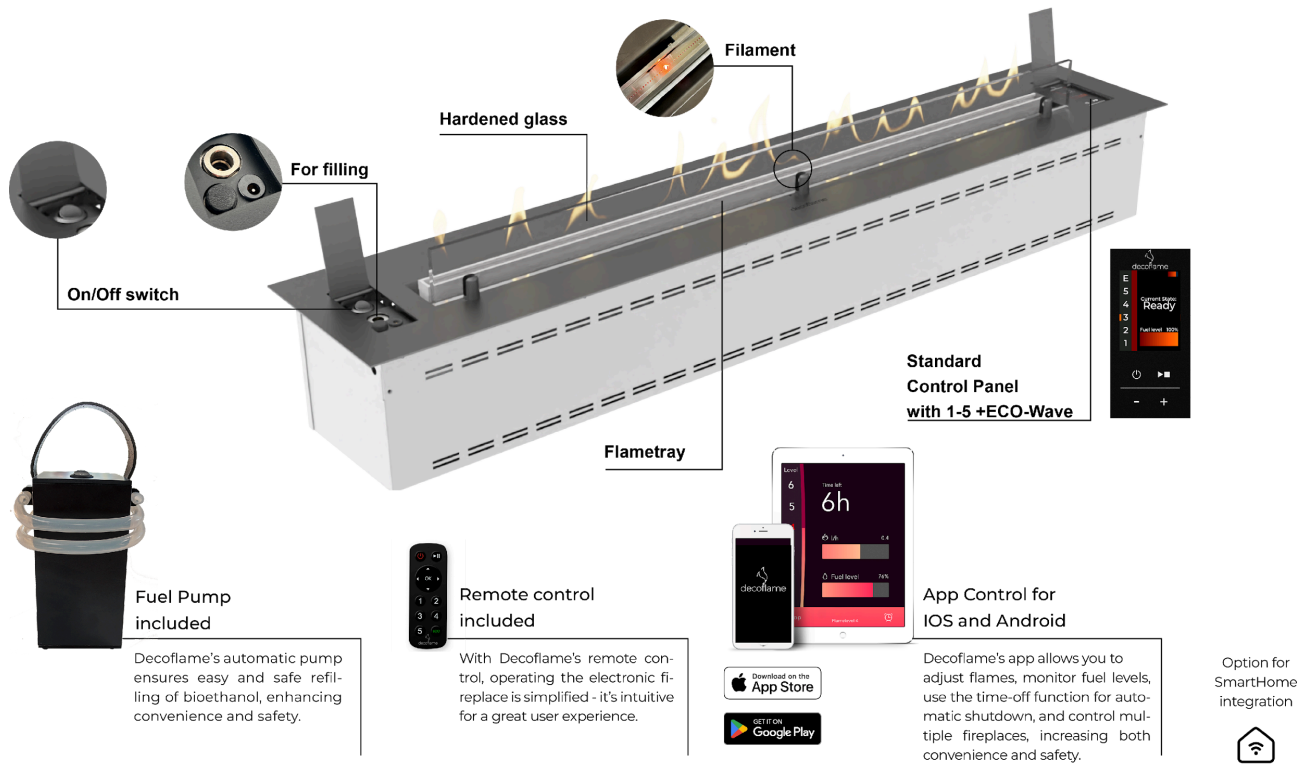

### GENERAL INFORMATION

Model	Denver F6
Configuration	2320 mm
Operation Type	Electronic
Production	Made in Denmark

### DESIGN & MATERIALS

Material	Stainless steel / Powder coated aluminum
Finish	Standard black powder coating
Glass Quality	Tempered diamond clear glass
Standard Glass	1x Low Glass

**BURNER SPECIFICATIONS**

Fuel Type	Bioethanol 95 - 96.5 %
Flametray (mm)	2100
Flame Levels	6 + ECO-Wave
Power Supply	230 V AC (220 V compatible), 50–60 Hz, earthed connection
Operation Type	Electronic
Chimney	Not Required

**PHYSICAL SPECIFICATIONS**

Gross Dimensions (mm)	W: 2320 × H: 160 × D: 215
Top Plate (mm)	L: 2320 × D: 215 × T: 2
Base Housing (mm)	W: 2300 × H: 158 × D: 190
Glass Dimensions (mm)	Low Glass: L: 2100 × H: 80 × T: 6
Weight: (kg)	33.0

**PERFORMANCE**

Capacity (L)	15.0
Max Level Burn Time (H)	6.5
Nominal Heat Output (kW)	13.4
Fuel consumption (ml/h)	N/A

**INSTALLATION REQUIREMENTS**

Power Supply	230 V AC (220 V compatible), 50–60 Hz, earthed connection
Minimum Room Size (m <sup>3</sup> )	268
Cut-out Dimensions (mm)	W: 2305 × H: 200 × D: 400
Installation Environment	Indoor

**FEATURES**

Safety Features	Automatic emergency shut-off / Spill- and Safety sensors
Add-on Features	SmartHome integration / Preparation for Automatic Tank System / Automatic Tank System 60 L + 10 m cable and hose
Included Features	e-Ribbon Technology / Remote Control / App Operation / Large Fuel Tank / External Fuel Pump with Quick Connection

**DISCLAIMER – DECOFLAME A/S**

All product specifications and technical data are subject to change without prior notice and are considered accurate as of the date of publication. Decoflame A/S, including its affiliates, employees, agents and other representatives (collectively referred to as "Decoflame A/S"), disclaims all liability for any errors, inaccuracies, or omissions in this document or in any other product-related information. Decoflame A/S shall not be held liable for any damage, loss, or indirect consequences arising from the use, installation, or operation of the products, unless otherwise required under applicable law. It is the user's responsibility to ensure correct installation and usage in accordance with applicable safety standards and the manufacturer's instructions. No licence, whether express or implied, to any intellectual property rights is granted through this document. Customers who use or sell Decoflame A/S products for purposes not explicitly specified do so at their own risk and agree to indemnify Decoflame A/S against any claims or damages resulting from such use. Fuel consumption may vary depending on individual units, environmental conditions, and operating parameters. Product images are for illustrative purposes only and may differ from the actual product. This limitation of liability does not apply where it would conflict with mandatory consumer protection laws.

## DENVER F6 - 2520 mm

Decoflame's Denver F6 bio-burner ranges from 520 mm to 3920 mm in length. Developed and manufactured locally, these burners offer exceptional flexibility for any project size. The Denver F6, designed by Decoflame's expert engineers, is a groundbreaking innovation in modern fireplaces. It impresses with advanced features, including app control, Bluetooth connectivity, and sophisticated safety systems. Additionally, it offers SmartHome integration and an external automated refuelling tank system, ensuring seamless and efficient operation.

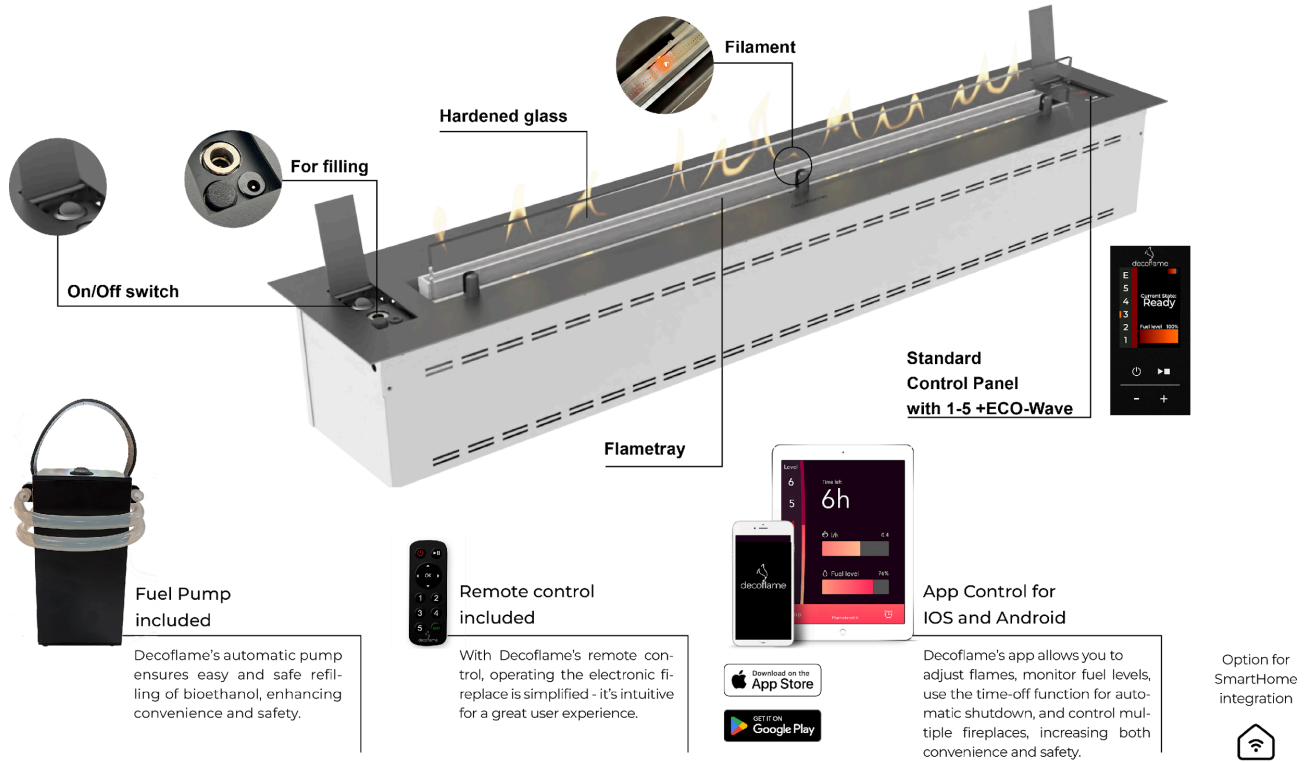

### GENERAL INFORMATION

Model	Denver F6
Configuration	2520 mm
Operation Type	Electronic
Production	Made in Denmark

### DESIGN & MATERIALS

Material	Stainless steel / Powder coated aluminum
Finish	Standard black powder coating
Glass Quality	Tempered diamond clear glass
Standard Glass	1x Low Glass

**BURNER SPECIFICATIONS**

Fuel Type	Bioethanol 95 - 96.5 %
Flametray (mm)	2300
Flame Levels	6 + ECO-Wave
Power Supply	230 V AC (220 V compatible), 50–60 Hz, earthed connection
Operation Type	Electronic
Chimney	Not Required

**PHYSICAL SPECIFICATIONS**

Gross Dimensions (mm)	W: 2520 × H: 160 × D: 215
Top Plate (mm)	L: 2520 × D: 215 × T: 2
Base Housing (mm)	W: 2500 × H: 158 × D: 190
Glass Dimensions (mm)	Low Glass: L: 2300 × H: 80 × T: 6
Weight: (kg)	35.0

**PERFORMANCE**

Capacity (L)	16.4
Max Level Burn Time (H)	6.5
Nominal Heat Output (kW)	14.7
Fuel consumption (ml/h)	N/A

**INSTALLATION REQUIREMENTS**

Power Supply	230 V AC (220 V compatible), 50–60 Hz, earthed connection
Minimum Room Size (m <sup>3</sup> )	293
Cut-out Dimensions (mm)	W: 2505 × H: 200 × D: 400
Installation Environment	Indoor

**FEATURES**

Safety Features	Automatic emergency shut-off / Spill- and Safety sensors
Add-on Features	SmartHome integration / Preparation for Automatic Tank System / Automatic Tank System 60 L + 10 m cable and hose
Included Features	e-Ribbon Technology / Remote Control / App Operation / Large Fuel Tank / External Fuel Pump with Quick Connection

**DISCLAIMER – DECOFLAME A/S**

All product specifications and technical data are subject to change without prior notice and are considered accurate as of the date of publication. Decoflame A/S, including its affiliates, employees, agents and other representatives (collectively referred to as "Decoflame A/S"), disclaims all liability for any errors, inaccuracies, or omissions in this document or in any other product-related information. Decoflame A/S shall not be held liable for any damage, loss, or indirect consequences arising from the use, installation, or operation of the products, unless otherwise required under applicable law. It is the user's responsibility to ensure correct installation and usage in accordance with applicable safety standards and the manufacturer's instructions. No licence, whether express or implied, to any intellectual property rights is granted through this document. Customers who use or sell Decoflame A/S products for purposes not explicitly specified do so at their own risk and agree to indemnify Decoflame A/S against any claims or damages resulting from such use. Fuel consumption may vary depending on individual units, environmental conditions, and operating parameters. Product images are for illustrative purposes only and may differ from the actual product. This limitation of liability does not apply where it would conflict with mandatory consumer protection laws.