

Assembly instructions

Visio 2 components



attika[®]
FEUERKULTUR

RAIS[®]
ART  OF FIRE

1. Contents

1. Contents.....	
2. Principle.....	2
3. General information	3-7
4. Parts list.....	8
5. Assembly	9-17
6. Technical drawing	18

2. Principle

All instructions provided with products must be followed. Damage occurring as a result of failure to follow these instructions is not covered by the guarantee, and no replacement parts can be claimed for such damage. Improperly performed work can lead to personal injury and material damage.

Room size and design must be suitable for the installation and proper use of our products.

When a fire is built-in, the manufacturer's specified dimensions and minimum requirements for openings and cladding must be observed.

When installing the product, all local rules and regulations (including those that refer to national and European standards) must be observed.

Current building regulations and rules in legislation must be observed.
The rules of the local authority on use of wood-burning stoves must be observed.

We guarantee a safe, energy-saving and environmentally friendly stove if these instructions are followed and the work performed correctly. The illustrations shown are indicative only.

Subject to technical changes, and changes in the range.

Transport damage must be reported immediately to the supplier.

Save instructions for future use.

3. General information

All of our fireplace inserts and stoves are tested and comply with the latest European norms and safety regulations. Because safety regulations for installation and operation of fireplaces vary from one country to another, the owner/operator of this product is responsible for compliance with the standards in your region and correct installation. The installation and operating instructions must be adhered to. RAIS/Attika cannot be held liable for incorrect installation or irresponsible operation.

Please observe all regional and local regulations regarding e.g.:

- Fire protection
- Safety distances
- Insulating materials
- Construction law
- Size of spark protection plates / floor plates
- Flue-pipe and chimney connections
- etc.

If you have any questions please contact your chimney sweep or the relevant government authorities.

Connection to the chimney

We recommend loose fitting of the elements without use of adhesive, so that you can adjust the height of the product before connection to the chimney. Use a spirit level to ensure that the elements are mounted horizontally.

The insert will expand when heated. Do not allow the elements to rest on the insert.

Always allow a space of at least 5 mm above the fireplace insert installation frame. No space is required on the side, but the distance between the bottom edge of the frame and the element must be minimum 2 mm.

Floor plates / front plates

A fireproof floor plate must be laid in front of and to the side of VISIO 2 Elements if the floor consists of combustible material. Please adhere to national, regional and local regulations.

Acrylic adhesive

The acrylic adhesive supplied is used to glue the elements together, and for gluing the elements to the wall and grouting. Make sure the adhesive surfaces and the surface are free of dust.

After assembling the elements, use the rest of the acrylic adhesive to fill the joints, or for grouting. Filling of the joints or grouting is an important part of the installation, and significantly contributes to the stability of the stove system.

Hairline cracks

Small cracks can appear between the elements and the point where the house wall meets the insert. This is perfectly normal and does not give cause for concern. Small cracks can be removed by grouting with *acrylic adhesive*. Scrape out grouting with a grouting scraper and use a vacuum cleaner to remove debris. Inject *acrylic adhesive* and spread using a soapy fingertip. The grout can be painted over after 24 hours.

Minor damage

Can be repaired with the *acrylic adhesive* supplied. In the event of more extensive damage, we recommend filling twice to avoid large settling cracks. Small, fine cracks and other unevenness should be filled using a small trowel or paint brush. Smooth the surface with a damp sponge or sandpaper.

Major damage

Any shipping damage must be reported directly to the carrier. Replacement parts can be claimed from RAIS A/S/Attika Feuer AG.

In the event of major damage that cannot be corrected using the powder adhesive, replacement can be requested as part of Attika Feuer AG's warranty provision.

Ordering spare parts:

When requesting spare parts, mark the damaged area on the packing label enclosed and take a photo of the damage. Send the photo and packing label RAIS A/S/Attika Feuer AG. Spare parts will be shipped as soon as possible.

Painting

You can paint the fireplace insert 24 hours after installation and grouting. Smooth down filled surfaces with a suitable abrasive. Use a mineral-based paint. Consult your local paint dealer or decorator.

RAIS A/S/Attika Feuer AG do not offer any guarantee for the final appearance of any unpainted building elements.

Granite or marble cornice boards/facades/benches

Clean with mild soapy water and remove excess glue immediately if there is residue left after installation. Never use acidic, aggressive products, as they can attack the surface and polish. Always use cleaning and sealing products permitted for cleaning and sealing marble and/or granite. Specialist stores can advise on various products for surface treatment and cleaning of natural stone. National and European standards, local building regulations and fire prevention provisions must be observed. Inform your chimney sweep before installation and first-time use.

Please comply with the setup and installation instructions for your own safety. All safety distances are minimum distances. When installing a fireplace, always comply with national, regional and local regulations.

RAIS/Attika cannot assume any responsibility, liability and/or guarantee for incorrect or modified fireplace installations. RAIS/Attika assume no liability for errors, misprints and changes.

Observe the separate installation instructions for the stove insert.

**Installation and operating instructions for the VISIO 2 stove insert tested in accordance with
DIN EN 13240**

Installation instructions

VISIO 2 is ready to connect, and must be connected to the existing building chimney with a connector. The connector should be as short and straight as possible, and should be installed horizontally or gently ascending. Connections must be sealed. National and European standards, local regulations, construction regulations and fire-authority provisions must be adhered to, so inform your district chimney sweep beforehand. Ensure that the requisite amount of air for combustion is available, especially in the event of tight-sealing windows and doors (sealing lip). The chimney calculation is to be in accordance with DIN EN 13384-1 or DIN EN 13384-2, applying the three exhaust specifications attached to these instructions. Before installing, check whether the load-bearing capacity of the substructure is sufficient for the weight of your room heater. In the event of an insufficient load-bearing capacity, appropriate measures (e.g. plate for load distribution) must be taken in order to attain it.

General safety instructions

Heat energy is released by the burning of fuel, leading to intense heating of the surfaces, the fire-chamber doors, the door and operating handles, the viewing window, the flue pipe and, where applicable, the front wall of the stove. Do not touch these parts without the relevant protective clothing or aids (heat-resistant gloves or other means of actuation). Make children aware of these dangers and keep them away from the stove while it is in use/hot.

Permissible fuels

The permissible fuel is firewood up to 33 cm long and up to 10 cm in diameter. Use only dry wood. Burning rubbish, particularly plastic, is prohibited. Doing so will also damage the fireplace and chimney, and can lead to damage to health and complaints by neighbours on account of odour nuisance. Air-dried firewood with a maximum water content of 20% requires the wood to be dried for a minimum of one year (softwood) or two years (hardwood). Wood is not a continuously burning fuel, thus it is not possible to heat the heat-producing appliance with wood overnight.

Lighting for the first time

The stove may give off an odour and smoke the first time you light it. This is because the paintwork and material need to harden, but the smell will quickly disappear. *Keep children and pets away from the stove while this is in progress.*

Lighting

Start by placing approx 1 kg of wood (e.g. two split logs) on the bottom of the combustion chamber. Lay approximately 1.2 kg dry split wood on top for kindling, along with 2 or 3 firelighters or similar. Never use alcohol, gasoline or other flammable liquids to light up. During the kindling phase, allow primary and secondary air into the stove. Shut off primary air once the fire is well alight. Control combustion using secondary air. Do not leave the stove unattended during this phase.

Operation of several heat-producing appliances

When operating several heat-producing appliances installed in a single room or in connected rooms, sufficient combustion ventilation is to be ensured.

Heating during the transitional period

During the transitional period, i.e. at higher outdoor temperatures, a sudden increase in temperature can lead to disturbances in the chimney draught, resulting in incomplete removal of the heating gases. The heat-production appliance must then be filled with small amounts of fuel and operated at a higher setting of the primary air slide/controller, so the existing fuel burns off faster (with flame development), thereby stabilising the chimney draught. To avoid resistance in the embers, the ash should frequently be carefully raked away.

Cleaning and inspection

Inspect the stove, flue gas tract and pipes each year, including after the chimney has been cleaned. Ensure that all built-up deposits are removed. The chimney must also be cleaned regularly by a chimney sweep. Your local chimney sweep will inform you of the required intervals. Have the stove inspected every year by an authorised expert.

Types

Stoves self-closing combustion chamber doors can be connected to a chimney already used for other stoves and cookers, unless the flue pipe dimension according to EN 12831 dictates otherwise. Stoves with self-closing doors must always be operated with the combustion chamber closed – except when lighting, putting fuel in and ash removal – to avoid the risk of damage to other fireplaces connected to the chimney, and to prevent leakage of combustion gases. Stoves without self-closing combustion chamber doors must be connected to their own chimney. Never operate with open combustion chamber without supervision. Refer to DIN EN 13384-1 or DIN EN 13384-2 for chimney dimensioning.

Combustion air

Since room heaters are room-air-dependent fire-producing appliances that take their combustion air from the installation room, the operator must ensure sufficient combustion air. With sealed windows and doors (e.g. in conjunction with energy-saving measures) a supply of fresh air may no longer be ensured, and this may impair the room heater's draught behaviour. This may affect your wellbeing and possibly your safety. If necessary an additional fresh-air supply must be provided, e.g. by installing an air valve near the room heater or by laying a combustion-air duct that takes the air out of the building or into a well-ventilated room (except for heating cellars). It must in particular be ensured that the requisite combustion-air ducts are open during operation of the fire-producing appliance. Extractor hoods that have been installed together with fire-producing appliances in the same room or connected rooms may adversely affect the function of the stove (possibly involving emission of smoke into the living room, despite a closed fire-chamber door), and must thus on no account be operated at the same time as the room heater.

Fire protection

Please note the declaration of performance.

Floors

Floors made of combustible materials in front of stove openings must be protected by non-flammable building materials. Such protection must comply with national building regulations.

Spare parts

Only use spare parts which have been expressly approved or supplied by the manufacturer. Please contact your dealer. Do not attempt to modify the fireplace!

Note regarding chimney fires

Use of incorrect fuel or fuel that is too damp may cause a chimney fire as a result of deposits in the chimney. Immediately close all air openings on the stove and notify the fire brigade. After the chimney has burnt out, have it checked by an expert for cracks or leaks.

Rated heat output, combustion-air settings and burn-up times

The room heater's rated heat output is 7 kW. It is achieved with a minimum feed pressure of 14 Pa. No more than 2 to 3 logs are to be added at once.

Chimney made of steel components

Can be connected to a chimney made of steel components.

Safety distance from combustible material

Ensure that all safety distances are adhered to.

Loosely set the stove cladding in order to mark the position and height of the flue-pipe connection. Also immediately mark a hole in the floor in case you would like to connect an air-intake kit (as an accessory).

Breakthroughs and outbreaks

Breakthroughs for the flue-pipe connection, air grids or other components in the chimney cladding must be created on site. They must be created applying extreme caution, to prevent breakage of the components.

Damage caused by improper work practices is not covered by the warranty.

Creating the breakthroughs with a drill:

Mark the requisite outbreaks on the parts. Perforate the contour with a drill. Break the sections between the individual drill holes with a hammer and then carefully knock the breakout in from the outside.

Plastering

Before plastering of the chimney cladding it should be heated once. The chimney cladding can thereby expand and dissipate the biggest tensions. This prevents and/or reduces later cracks in the surface of the plastered chimney.

Wipe the surface of the chimney cladding with a damp cloth. Prewetting of the substrate is not necessary.

Keep processing temperatures >5°C.

In order to as far as possible avoid stress cracks, a fibreglass grid is applied to the chimney cladding using adhesive plaster.

The actual layer of plaster is then applied over this layer using adhesive plaster.

NB: Observe the processing instructions accompanying the adhesive plaster.

Extract from the processing instructions: Thoroughly mix the dry matter in a clean container before removing quantities for processing. Using a spatula or trowel, blend small quantities in the masonry pan with clean tap water to an application-specific consistency, and process it quickly. When mixing for large areas, stir intensively with a mortar agitator at low revs, allow it to settle, stir again and then quickly process it.

4. Parts list

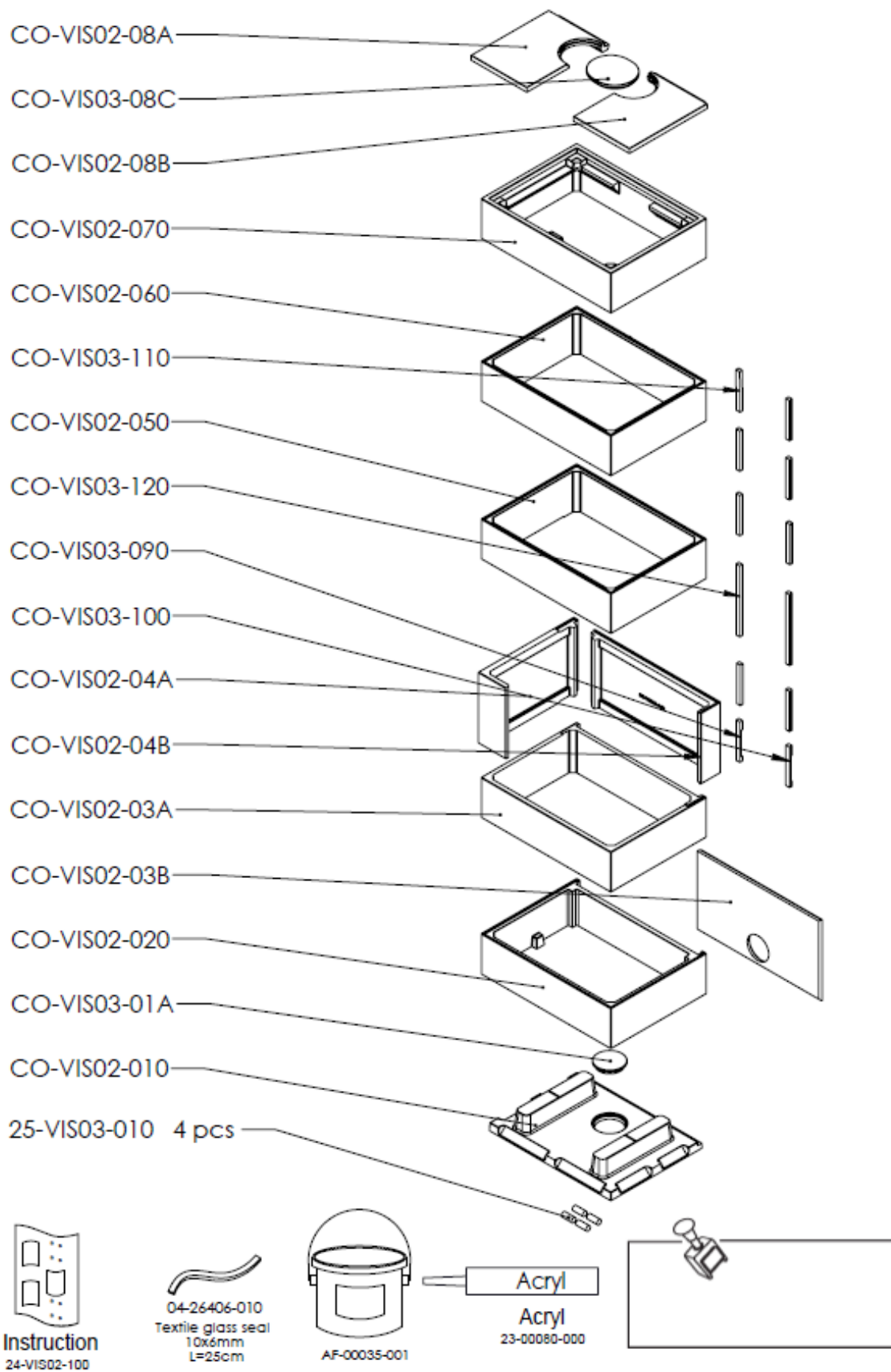

5. Assembly

- 1 Place the CO-VIS02-010 base plate on the floor at the installation site (see Fig. 1)



Fig. 1

2. Place VISIO 2 on the base plate in such a way that the distance (front & glass side panel side) from the base plate to the outer edge of the supporting frame is 38 mm (see Fig. 2). The distance between the floor and the lower edge of the supporting frame of the chimney insert must be at least 544 mm. (See Fig. 3). The height of the chimney insert can be adjusted via the adjustable feet.

Notes if the chimney kit is positioned flush with a wall:

- The transportation protection for the stove insert must be removed before positioning. Notes on removing the transportation protection are to be found in the stove insert's installation instructions.
- If the chimney kit is positioned against a combustible wall, then in addition two CO-VIS03-100 spacers, eight CO-VIS03-110 spacers and two CO-VIS03-120 spacers must be adhered to the chimney kit using the acrylic adhesive.

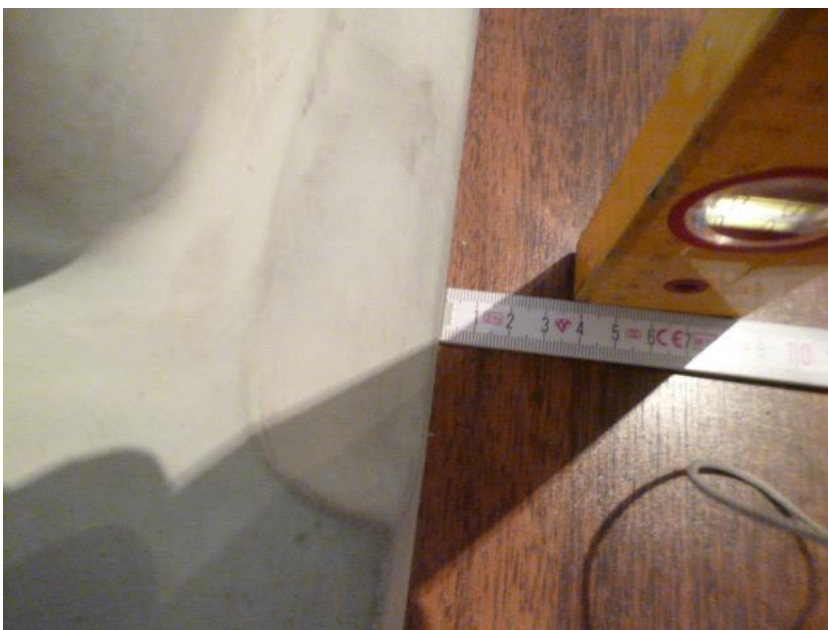

Fig. 2



Fig. 3

3. For the components C0-VIS02-020 and C0-VIS02-03A separate off the rear wall (e.g. using an angle cutter). The cuts must be made in the notches. (See Figs. 4 & 5).



Fig. 4



Fig. 5

4. Place the CO-VIS02-03A component on the CO-VIS02-020 component and push it under the stove insert using the wooden rollers supplied (see Figs. 6 & 7).



Fig. 6



Fig. 7

5. Remove the transportation protection from the chimney insert (see Figs. 8 & 9). Notes on removing the transportation protection are to be found in the stove insert's installation instructions.



Fig. 8



Fig. 9

6. Insert the CO-VIS02-03B rear-wall plate and attach it using the acrylic adhesive. The adhesive will set within 10 minutes (see Fig. 10).



Fig. 10

7. Position the C0-VIS02-04A component (see Fig. 11).



Fig. 11

8. Position the C0-VIS02-04B component (see Fig. 12).



Fig. 12

9. For the CO-VIS02-050 ring component, adhere the accompanying seals at the front between the ring component and the chimney insert's supporting frame. One to the left and one to the right below the ring component (see Fig. 13).
Then lift and position the CO-VIS02-050 ring component over the stove insert (see Fig. 14).



Fig. 13



Fig. 14

10. If the VISIO 2 component is installed with exhaust flue at the rear, the outbreaks for the flue-pipe connection must be created on the components C0-VIS02-60 and C0-VIS02-70. Notes on implementation are to be found on p. 7 of these instructions.

VISIO 2 component corner right = break out red circle (see Fig. 15)
VISION 2 component corner left = break out blue circle

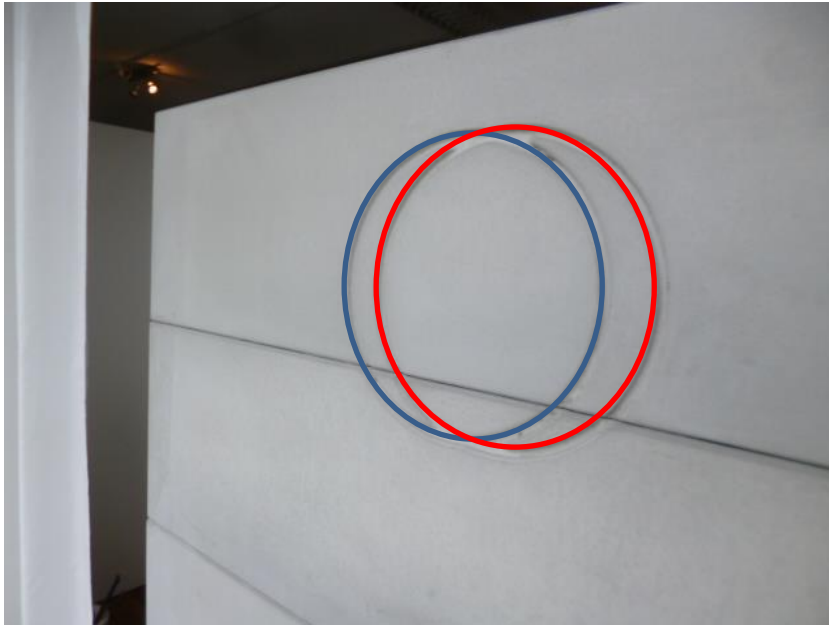

Fig. 15

Lift and position the C0-VIS02-060 ring component over the stove insert (see Fig. 16).



Fig. 16

11. Lift and position the CO-VIS02-070 ring component over the stove insert (see Fig. 17).



Fig. 17

12. Position cover plates CO-VIS02-08A and CO-VIS02-08B on the CO-VIS02-070 ring component. (See Fig. 18).



Fig. 18

FINISHED

6. Technical drawing

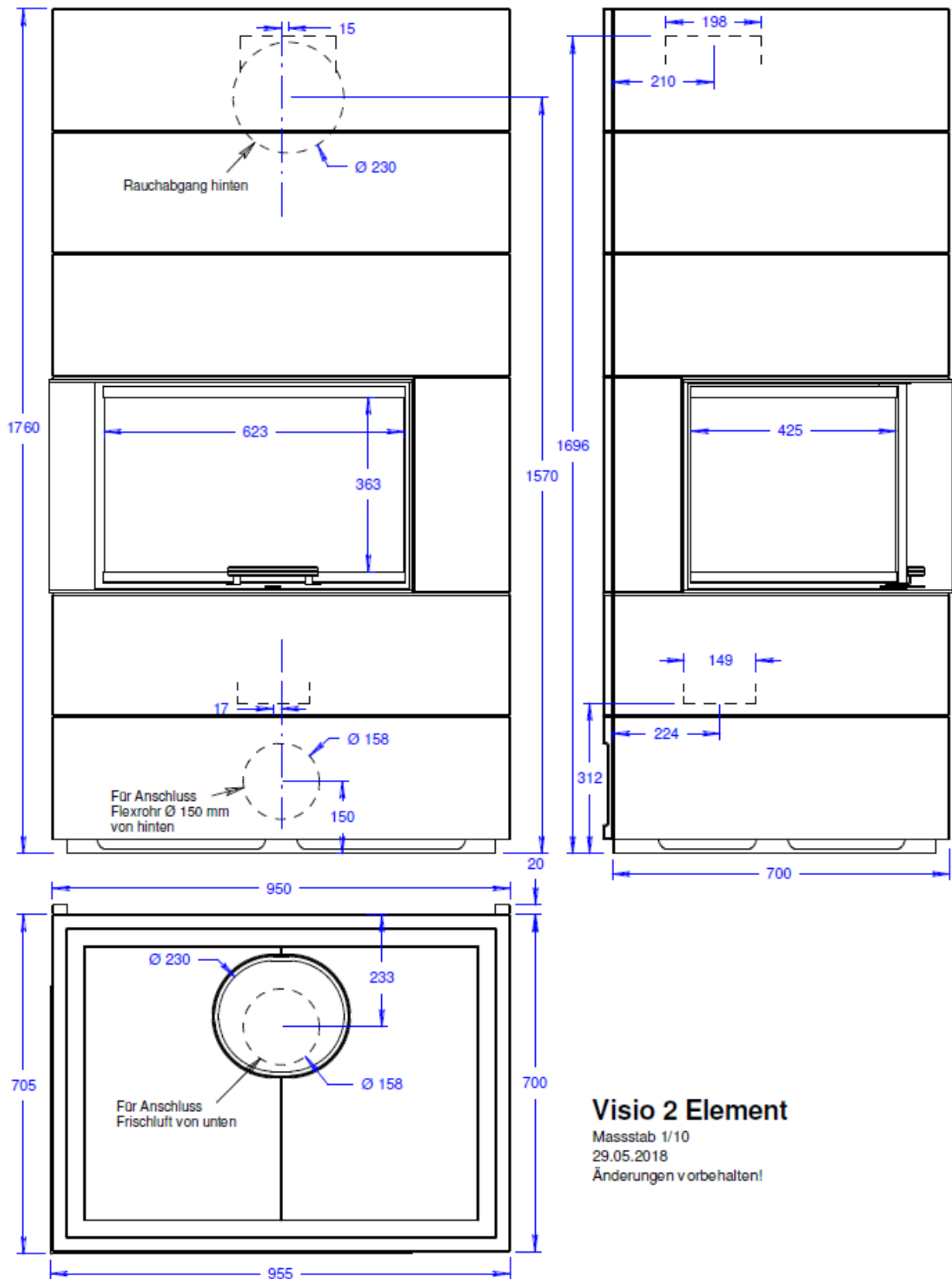

Visio 2 Element

Maßstab 1/10
29.05.2018
Änderungen vorbehalten!